

4611110015387

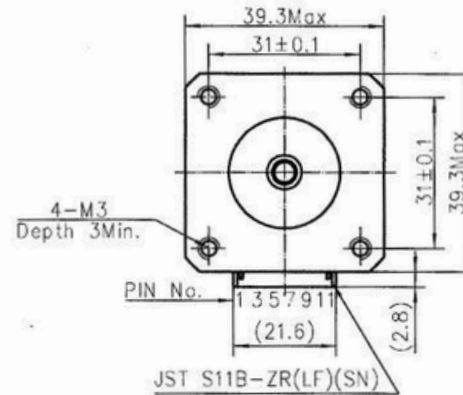

Wiring Diagram

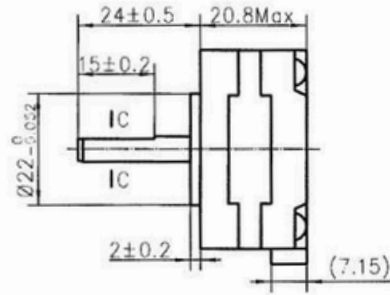
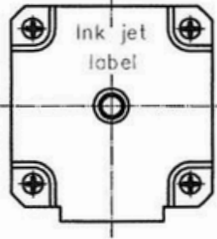
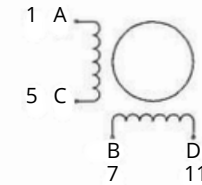

Exciting Sequence vs. Direction of Rotation

STEP	A	B	C	D	
1	+	+	-	-	CCW ↑
2	-	+	+	-	
3	-	-	+	+	
4	+	-	-	+	

Clockwise view from mounting side

Specifications

1. Number of Phase	2
2. Step Angle	1.8°
3. Rated Voltage	3.92V DC
4. Rated Current	0.7Amp
5. Holding Torque	0.1N.m Typ (Two phase on/rated current)
6. Phase Resistance	5.6ohm ± 10% (20°C)
7. Phase Inductance	5.6mH ± 20% (1kHz 1V rms)
8. Rotor Inertia	14g.cm ²
9. Motor Weight	110g
10. Insulation Class	B(130°C)

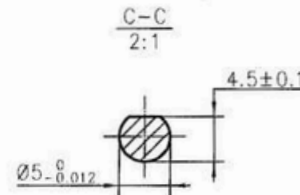

Label Detail

MOONS' STEPPING MOTOR
TYPE MS16HS7P4070
XXXXXXXX YY/MM/DD

Work Order

Date Format

Unit: mm

FIRST ANGLE METHOD

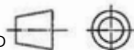

Tolerance for linear and regular dimension without individual tolerance indications
GB/T 1804-m egv ISO 2768-1: m

Geometrical tolerance for features without individual tolerance indications
GB/T 1184-K egv ISO 2768-2: K

Approve

Standard

Technology

Check

Design

NAMES

SIGNATURE

DATE

Type: MS16HS7P4070

Rev.A

SCALE 1:1

Sheet 1 of 1

PIVEXIN
TECHNOLOGY

REV.	REVISION RECORD	DATE
A	Original revision	2013.04.03